

It's like having a guard in each guestroom



### The difference is easy to see

With one glance at an Elsafe Sentinel Plus, you can see that it is much more than a typical in-room safe. It's sleek profile, sharp LED display and ergonomic design make it easy to distinguish. But with the Sentinel Plus, the difference is as much in what you don't see as what you do. Underneath that unique, stylish exterior is an array of technological advancements that make it an excellent choice for your guestroom security. With heavy-gauge steel construction and added security features, including a revolutionary locking mechanism, anti-tamper labyrinths, and extended solid-steel hinges, the Sentinel

Series provides virtually the most secure in-room safe in the world today. Its modular construction makes adding features or upgrading to new technology as easy as changing a panel. Sentinel Plus is also simple to use. A highly visible LED display allows guests to intuitively enter their personally-chosen 4-digit PIN code that operates the safe. There are no keys or cards to misplace, and the private PIN code gives your guests added peace of mind. In addition, you'll have the security of knowing that your in-room safes are backed by the worldwide leader in electronic safe technology. Now that's a difference that's easy to see.

## SENTINEL Plus



### FEATURES

- Simple 4-digit PIN code operation
- Highly visible LED display
- Revolutionary locking system with inter-locking deadbolt mechanism
- One piece, cold-pressed curved door is over 70% stronger than flat steel doors
- Extended solid steel bolt hinges for maximum security and durability
- Solid, arc-welded heavy-gauge steel construction and recessed back for superior strength and security
- Anti-tamper, auto relock function
- Three convenient standard sizes available
- Attractive, ergonomic design
- Unique modular construction for easy upgradability

## TECHNICAL INFORMATION

With the state of the art security features offered in the Sentinel Series of in-room safes, there is simply no better way to protect the property of your guests at such an affordable price. Based upon the Elsafe industry-leading Infinity Collection that has been widely applauded since being introduced, the Sentinel Series is setting new standards for strength and security, while offering an economical solution that won't break your budget.

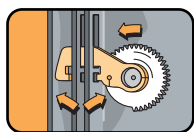

ELSAFE'S REVOLUTIONARY LOCKING SYSTEM RESISTS FORCIBLE ENTRY.

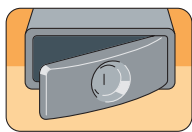

ONE-PIECE COLD-PRESSED DOOR IS OVER 70% STRONGER THAN FLAT STEEL DOORS.

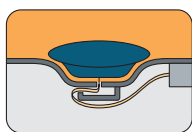

ANTI-TAMPER LABYRINTHS PROTECT SENTINEL ELECTRONICS FROM MANIPULATION.

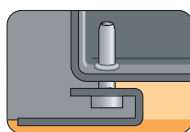

EXTENDED SOLID STEEL BOLT HINGES ARE SECURE AND ULTRA-RELIABLE.

| <b>Sentinel Plus</b> |   | Model code SP                   |                      |                           |
|----------------------|---|---------------------------------|----------------------|---------------------------|
| Sizes                |   | 25, 41 and 49 cm external depth |                      |                           |
| Measurements         |   | SK25                            | SK41                 | SK49                      |
| Outside H/W/D        | mm  | 200/432,3/250                   | 200/432,2/412,6      | 200/432,2/493,4           |
|                      | in  | 7 7/8 / 17 / 9 7/8              | 7 7/8 / 17 / 16 1/4  | 7 7/8 / 17 / 19 1/2       |
| Inside H/W/D         | mm  | 196/428,2/142,8                 | 196/428,2/304,5      | 196/428,2/385,3           |
|                      | in  | 7 3/4 / 160 7/8 / 5 5/8         | 7 3/4 / 160 7/8 / 12 | 7 3/4 / 160 7/8 / 15 5/32 |
| Door opening H/W     | mm  | 148/320                         | 148/320              | 148/320                   |
|                      | in  | 5 3/4 / 12 9/16                 | 5 3/4 / 12 9/16      | 5 3/4 / 12 9/16           |
| Internal volume      | litres  | 12                              | 25,5                 | 32,3                      |
|                      | cu ft   | 0,4                             | 1                    | 1,1                       |
| Weight               | kg  | 10,8                            | 13,9                 | 15,5                      |
|                      | lb  | 23,8                            | 30,6                 | 34,2                      |
| Locking mechanism    | Inter-locking deadbolt mechanism                      |                                 |                      |                           |
| Locking/access code  | 4-digit   |                                 |                      |                           |
| Closing              | Push button   |                                 |                      |                           |
| Inside carpet        | Yes   |                                 |                      |                           |
| Display              | Yes   |                                 |                      |                           |
| Beeper               | No  |                                 |                      |                           |
| Override             | Electronic key, Service unit Sentinel or the Safelink |                                 |                      |                           |
| Memory function      | No  |                                 |                      |                           |
| Power supply         | 5 A4-cells in keyboard                                |                                 |                      |                           |
| Steel thickness      | Door, frame and back-wall: 2,5 mm / Body: 2 mm        |                                 |                      |                           |
| Fastening methods    | Back wall: 2 bolts / Bottom: 4 bolts                  |                                 |                      |                           |

The Sentinel series consists of three more models:



Sentinel Advanced: One eye on the future – the other on the past.



Sentinel Standard: Basic digital security taken to a new level.



Sentinel SmartKey: A simple solution to superior guestroom security.