

It's like having a guard in each guestroom



SENTINEL

SmartKey



A simple solution to superior guestroom security

The Sentinel SmartKey in-room safe combines the unparalleled security of an industry-leading Elsafe in-room safe at an unbelievably affordable price. With this revolutionary new model, Elsafe introduces an entirely new concept in access technology that is destined to make all metal key safes in the industry obsolete. Its simple design and ease of operation makes it convenient for your guests to use, yet very economical for you to purchase and to maintain. There are no expensive cylinders

to replace if guests lose a key. And the smartcard key system is as easy for your staff as it is for guests. Simply hand guests any smartcard from your pre-programmed stack of cards and it becomes a unique key for that safe. In addition, you'll have the security of knowing that your in-room safes are provided by the worldwide leader in electronic safe technology, proven by over 20 years experience in the industry and backed by the world's largest and most powerful lock group - Assa Abloy. Simply put - it's unparalleled value for money!

FEATURES

- Simple smartcard-operated access system
- Revolutionary locking system with inter-locking deadbolt mechanism
- One piece, cold-pressed curved door is over 70% stronger than flat steel doors
- Extended solid steel bolt hinges for maximum security and durability
- Solid, arc-welded heavy-gauge steel construction and recessed back for superior strength and security
- Anti-tamper, auto relock function
- Three convenient standard sizes available
- Attractive, ergonomic design
- Unique modular construction for easy upgradability

TECHNICAL INFORMATION

With the state of the art security features offered in the Sentinel Series of in-room safes, there is simply no better way to protect the property of your guests at such an affordable price. Based upon the Elsafe industry-leading Infinity Collection that has been widely applauded since being introduced, the Sentinel Series is setting new standards for strength and security, while offering an economical solution that won't break your budget.

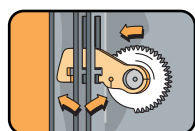

ELSAFE'S REVOLUTIONARY LOCKING SYSTEM RESISTS FORCIBLE ENTRY.

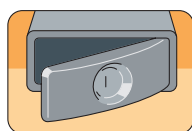

ONE-PIECE COLD-PRESSED DOOR IS OVER 70% STRONGER THAN FLAT STEEL DOORS.

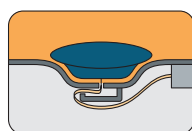

ANTI-TAMPER LABYRINTHS PROTECT SENTINEL ELECTRONICS FROM MANIPULATION.

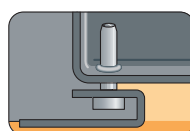

EXTENDED SOLID STEEL BOLT HINGES ARE SECURE AND ULTRA-RELIABLE.

Sentinel SmartKey		Model code SK		
Sizes		25, 41 and 49 cm external depth		
Measurements		SK25	SK41	SK49
Outside H/W/D	mm	200/432,3/250	200/432,2/412,6	200/432,2/493,4
	in	7 7/8 / 17 / 9 7/8	7 7/8 / 17 / 16 1/4	7 7/8 / 17 / 19 1/2
Inside H/W/D	mm	196/428,2/142,8	196/428,2/304,5	196/428,2/385,3
	in	7 3/4 / 160 7/8 / 5 5/8	7 3/4 / 160 7/8 / 12	7 3/4 / 160 7/8 / 15 5/32
Door opening H/W	mm	148/320	148/320	148/320
	in	5 3/4 / 12 9/16	5 3/4 / 12 9/16	5 3/4 / 12 9/16
Internal volume	litres	12	25,5	32,3
	cu ft	0,4	1	1,1
Weight	kg	10,8	13,9	15,5
	lb	23,8	30,6	34,2
Locking mechanism	Inter-locking deadbolt mechanism			
Locking/access code	Preprogrammed smartcard			
Closing	Automatic			
Inside carpet	Yes			
Display	No			
Beeper	No			
Override	Electronic key or the SafeLink			
Memory function	No			
Power supply	4 A4-cells in keyboard			
Steel thickness	Door, frame and back-wall: 2,5 mm / Body: 2 mm			
Fastening methods	Back wall: 2 bolts / Bottom: 4 bolts			

The Sentinel series consists of three more models:



Sentinel Advanced: One eye on the future – the other on the past.



Sentinel Plus: The difference is easy to see.



Sentinel Standard: Basic digital security taken to a new level.